

**WELCOME**

**to the**

**Park Hill Storm  
Phase V Project**

**PUBLIC**

**OPEN**

**HOUSE**

**Please Sign In**



# Park Hill Storm Phase V Project

## Project Overview

Park Hill Storm Phase V Project will be installing an 84" storm drainage pipe and a 24" sanitary sewer pipe in Dahlia Street between 48th Avenue and just up to Smith Road (before the railroad tracks). The purpose of the project is to reduce localized flooding problems and damage to roadways and private property. The Park Hill Storm Phase V Project is the continuation of the Phase IV project completed in 2014.

### Project Schedule

**March 2017 to October 2017** – Utility Relocation Phase – Ongoing

**October 2017 to October 2018** – Storm and Sanitary Construction Phase

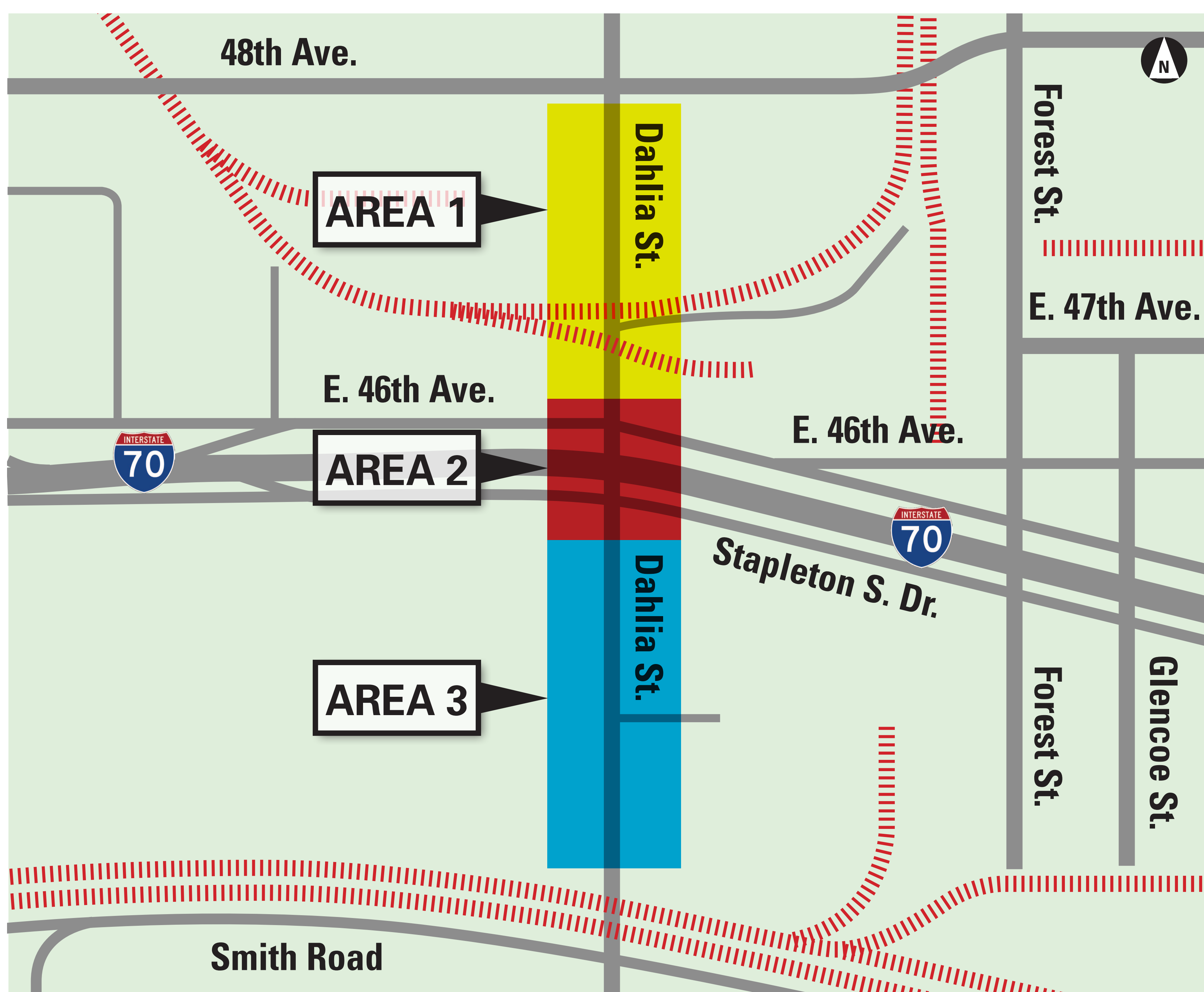

# Park Hill Storm Phase V Project Area 1

The project has been divided into three areas. Each area has different access needs and/or constraints. Work may occur in all three areas simultaneously to maintain the project schedule. Construction work includes installation of a 24" and an 84" pipe and associated laterals, relocation of water lines, removal and replacement of railroad track crossings, paving and repairing sidewalks, curbs and gutters.

Area 1 is located from 48th Avenue to approximately Stapleton Drive North. The area has 8 businesses that will be impacted by the construction. Access to these businesses will be maintained through approved traffic control plans, close coordination and communications with each business for the duration of the project.

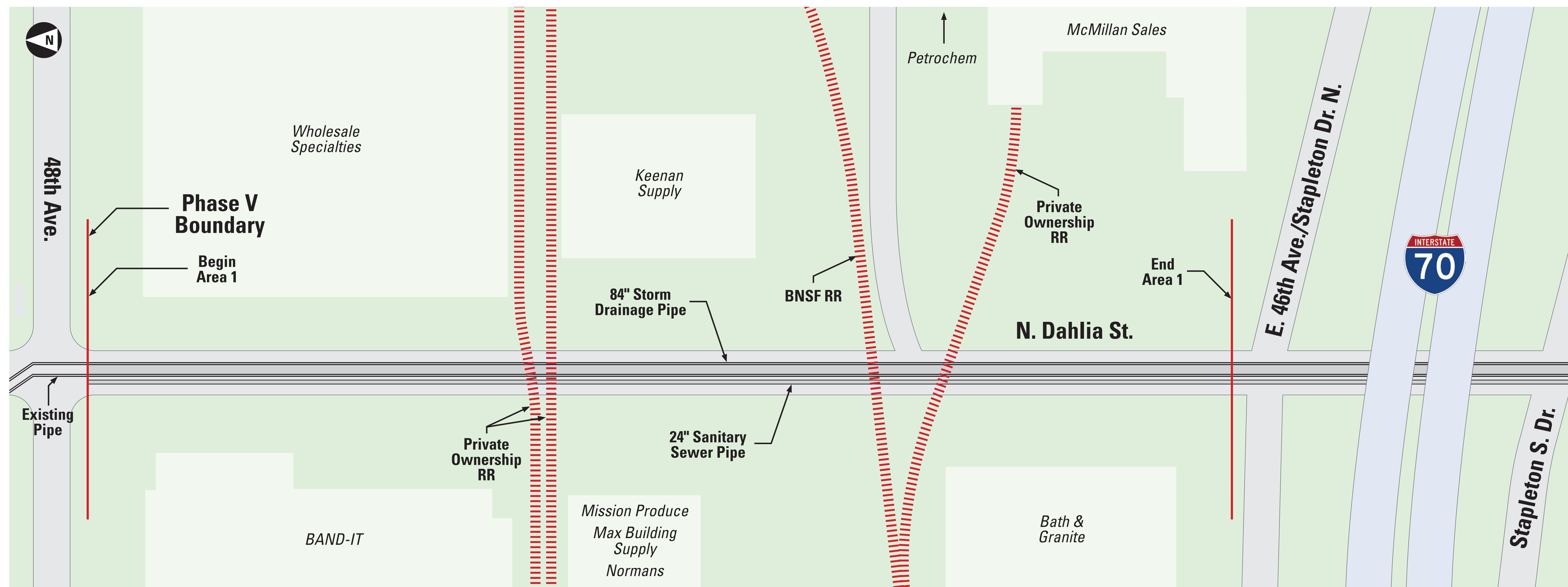

# Park Hill Storm Phase V Project

## Area 2

Area 2 is located approximately from Stapleton Drive North to Stapleton Drive South. No business access will be impacted in this area. The construction crew will be tunneling a 24" sanitary sewer

pipe and an 84" storm drainage pipe, constructing associated laterals, installing permeation grouting, relocating water lines, paving and repairing sidewalks, curbs and gutters.

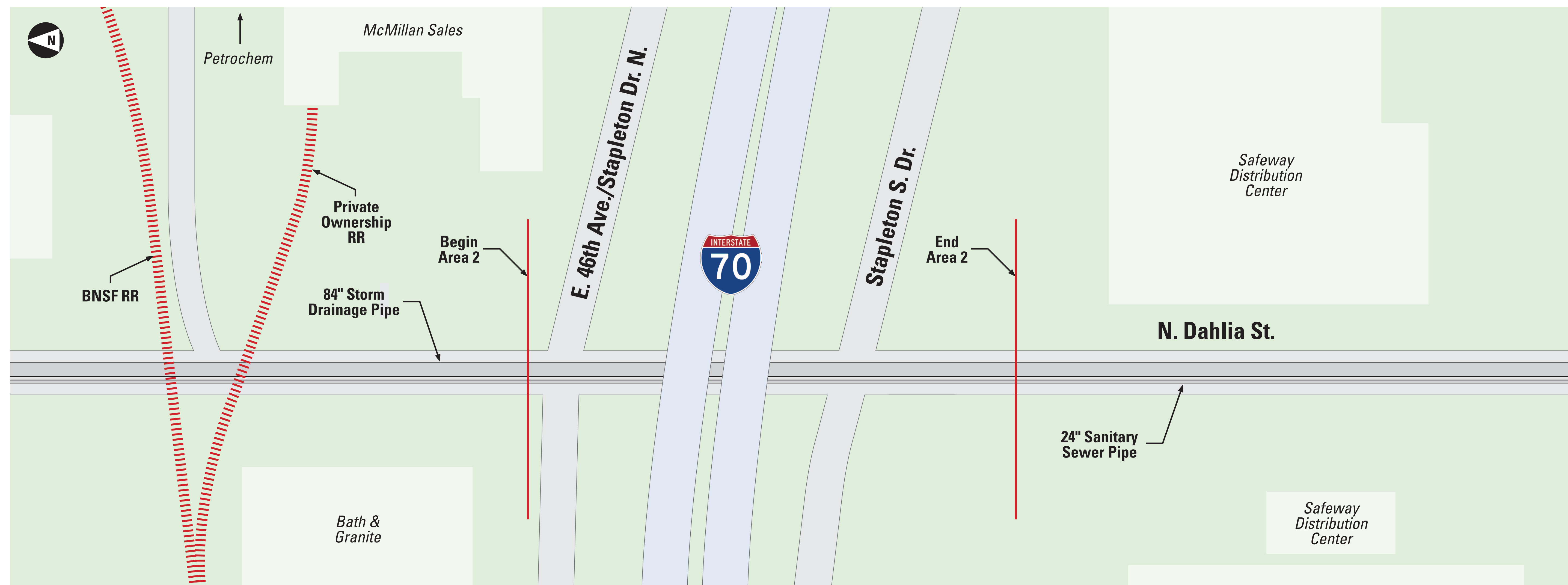

# Park Hill Storm Phase V Project Area 3

Area 3 is located approximately from Stapleton Drive South to the UPRR railroad tracks. Only 1 business, Safeway, will be impacted in this area. The project crew will be installing a 24" sanitary sewer pipe and an 84" storm drainage pipe, constructing associated laterals,

relocating water lines, paving, and repairing sidewalks, curbs, and gutters. Access to the Safeway distribution center will be maintained through approved traffic control plans, and close coordination and communications with Safeway management throughout the project.

